

Flood Plan



NEW TOWN BUILDERS
1738 S. F. TOWN
PO BOX 131811
DENVER, CO 80213
www.newtownbuilders.com

THE CONGRESS PARK COLLECTION AT BELLE CREEK
1738 S. F. TOWN
DENVER, CO 80213
NEW TOWN BUILDERS
1738 S. F. TOWN
DENVER, CO 80213

THE CONGRESS PARK COLLECTION
PLAN 010

PROJECT #	1738 S. F. TOWN
DATE	08/11/11
DESIGNED BY	NEW TOWN BUILDERS
DATE	08/11/11
SCALE	AS SHOWN
PROJECT	1738 S. F. TOWN
DATE	08/11/11

PLAN 010
1738 S. F. TOWN
A2.4

- GENERAL NOTES**
1. ALL DIMENSIONS UNLESS OTHERWISE NOTED ARE IN FEET AND INCHES.
 2. FINISH FLOOR IS 4" ABOVE FINISH GRADE UNLESS OTHERWISE NOTED.
 3. FINISH GRADE IS 1" ABOVE FINISH FLOOR UNLESS OTHERWISE NOTED.
 4. FINISH GRADE IS 1" ABOVE FINISH FLOOR UNLESS OTHERWISE NOTED.
 5. FINISH GRADE IS 1" ABOVE FINISH FLOOR UNLESS OTHERWISE NOTED.
 6. FINISH GRADE IS 1" ABOVE FINISH FLOOR UNLESS OTHERWISE NOTED.
 7. FINISH GRADE IS 1" ABOVE FINISH FLOOR UNLESS OTHERWISE NOTED.
 8. FINISH GRADE IS 1" ABOVE FINISH FLOOR UNLESS OTHERWISE NOTED.
 9. FINISH GRADE IS 1" ABOVE FINISH FLOOR UNLESS OTHERWISE NOTED.
 10. FINISH GRADE IS 1" ABOVE FINISH FLOOR UNLESS OTHERWISE NOTED.
 11. FINISH GRADE IS 1" ABOVE FINISH FLOOR UNLESS OTHERWISE NOTED.
 12. FINISH GRADE IS 1" ABOVE FINISH FLOOR UNLESS OTHERWISE NOTED.
 13. FINISH GRADE IS 1" ABOVE FINISH FLOOR UNLESS OTHERWISE NOTED.
 14. FINISH GRADE IS 1" ABOVE FINISH FLOOR UNLESS OTHERWISE NOTED.
 15. FINISH GRADE IS 1" ABOVE FINISH FLOOR UNLESS OTHERWISE NOTED.
 16. FINISH GRADE IS 1" ABOVE FINISH FLOOR UNLESS OTHERWISE NOTED.
 17. FINISH GRADE IS 1" ABOVE FINISH FLOOR UNLESS OTHERWISE NOTED.
 18. FINISH GRADE IS 1" ABOVE FINISH FLOOR UNLESS OTHERWISE NOTED.
 19. FINISH GRADE IS 1" ABOVE FINISH FLOOR UNLESS OTHERWISE NOTED.
 20. FINISH GRADE IS 1" ABOVE FINISH FLOOR UNLESS OTHERWISE NOTED.

- FIRE SEPARATION NOTES**
1. ALL FIRE SEPARATION WALLS SHALL BE CONSTRUCTED IN ACCORDANCE WITH THE 2009 INTERNATIONAL RESIDENTIAL CODE (IRC) AND THE 2009 INTERNATIONAL FIRE CODE (IFC).
 2. ALL FIRE SEPARATION WALLS SHALL BE CONSTRUCTED WITH 1/2" GYPSUM BOARD ON BOTH SIDES OF THE WALL.
 3. ALL FIRE SEPARATION WALLS SHALL BE CONSTRUCTED WITH 2" MINIMUM THICKNESS.
 4. ALL FIRE SEPARATION WALLS SHALL BE CONSTRUCTED WITH 1" MINIMUM THICKNESS.
 5. ALL FIRE SEPARATION WALLS SHALL BE CONSTRUCTED WITH 1" MINIMUM THICKNESS.
 6. ALL FIRE SEPARATION WALLS SHALL BE CONSTRUCTED WITH 1" MINIMUM THICKNESS.
 7. ALL FIRE SEPARATION WALLS SHALL BE CONSTRUCTED WITH 1" MINIMUM THICKNESS.
 8. ALL FIRE SEPARATION WALLS SHALL BE CONSTRUCTED WITH 1" MINIMUM THICKNESS.
 9. ALL FIRE SEPARATION WALLS SHALL BE CONSTRUCTED WITH 1" MINIMUM THICKNESS.
 10. ALL FIRE SEPARATION WALLS SHALL BE CONSTRUCTED WITH 1" MINIMUM THICKNESS.
 11. ALL FIRE SEPARATION WALLS SHALL BE CONSTRUCTED WITH 1" MINIMUM THICKNESS.
 12. ALL FIRE SEPARATION WALLS SHALL BE CONSTRUCTED WITH 1" MINIMUM THICKNESS.
 13. ALL FIRE SEPARATION WALLS SHALL BE CONSTRUCTED WITH 1" MINIMUM THICKNESS.
 14. ALL FIRE SEPARATION WALLS SHALL BE CONSTRUCTED WITH 1" MINIMUM THICKNESS.
 15. ALL FIRE SEPARATION WALLS SHALL BE CONSTRUCTED WITH 1" MINIMUM THICKNESS.
 16. ALL FIRE SEPARATION WALLS SHALL BE CONSTRUCTED WITH 1" MINIMUM THICKNESS.
 17. ALL FIRE SEPARATION WALLS SHALL BE CONSTRUCTED WITH 1" MINIMUM THICKNESS.
 18. ALL FIRE SEPARATION WALLS SHALL BE CONSTRUCTED WITH 1" MINIMUM THICKNESS.
 19. ALL FIRE SEPARATION WALLS SHALL BE CONSTRUCTED WITH 1" MINIMUM THICKNESS.
 20. ALL FIRE SEPARATION WALLS SHALL BE CONSTRUCTED WITH 1" MINIMUM THICKNESS.

- FINISH GRADE NOTES**
1. FINISH GRADE IS 1" ABOVE FINISH FLOOR UNLESS OTHERWISE NOTED.
 2. FINISH GRADE IS 1" ABOVE FINISH FLOOR UNLESS OTHERWISE NOTED.
 3. FINISH GRADE IS 1" ABOVE FINISH FLOOR UNLESS OTHERWISE NOTED.
 4. FINISH GRADE IS 1" ABOVE FINISH FLOOR UNLESS OTHERWISE NOTED.
 5. FINISH GRADE IS 1" ABOVE FINISH FLOOR UNLESS OTHERWISE NOTED.
 6. FINISH GRADE IS 1" ABOVE FINISH FLOOR UNLESS OTHERWISE NOTED.
 7. FINISH GRADE IS 1" ABOVE FINISH FLOOR UNLESS OTHERWISE NOTED.
 8. FINISH GRADE IS 1" ABOVE FINISH FLOOR UNLESS OTHERWISE NOTED.
 9. FINISH GRADE IS 1" ABOVE FINISH FLOOR UNLESS OTHERWISE NOTED.
 10. FINISH GRADE IS 1" ABOVE FINISH FLOOR UNLESS OTHERWISE NOTED.
 11. FINISH GRADE IS 1" ABOVE FINISH FLOOR UNLESS OTHERWISE NOTED.
 12. FINISH GRADE IS 1" ABOVE FINISH FLOOR UNLESS OTHERWISE NOTED.
 13. FINISH GRADE IS 1" ABOVE FINISH FLOOR UNLESS OTHERWISE NOTED.
 14. FINISH GRADE IS 1" ABOVE FINISH FLOOR UNLESS OTHERWISE NOTED.
 15. FINISH GRADE IS 1" ABOVE FINISH FLOOR UNLESS OTHERWISE NOTED.
 16. FINISH GRADE IS 1" ABOVE FINISH FLOOR UNLESS OTHERWISE NOTED.
 17. FINISH GRADE IS 1" ABOVE FINISH FLOOR UNLESS OTHERWISE NOTED.
 18. FINISH GRADE IS 1" ABOVE FINISH FLOOR UNLESS OTHERWISE NOTED.
 19. FINISH GRADE IS 1" ABOVE FINISH FLOOR UNLESS OTHERWISE NOTED.
 20. FINISH GRADE IS 1" ABOVE FINISH FLOOR UNLESS OTHERWISE NOTED.

1 MAIN LEVEL PLAN
1738 S. F. TOWN
DENVER, CO 80213
NEW TOWN BUILDERS
1738 S. F. TOWN
DENVER, CO 80213

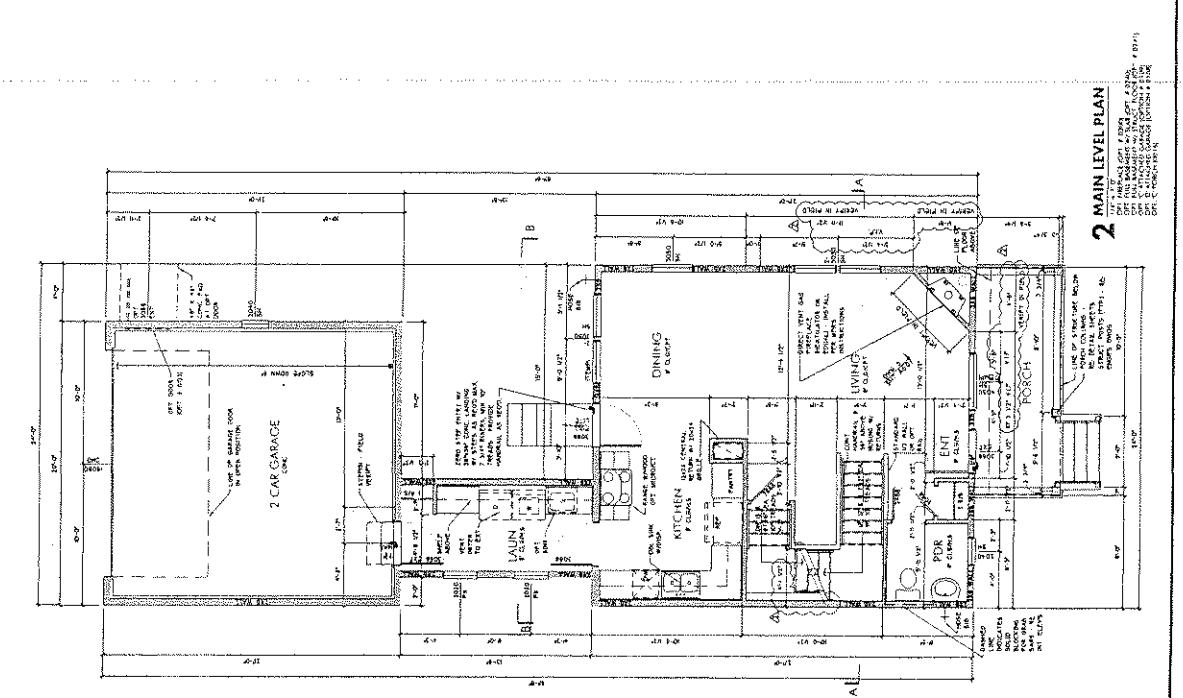
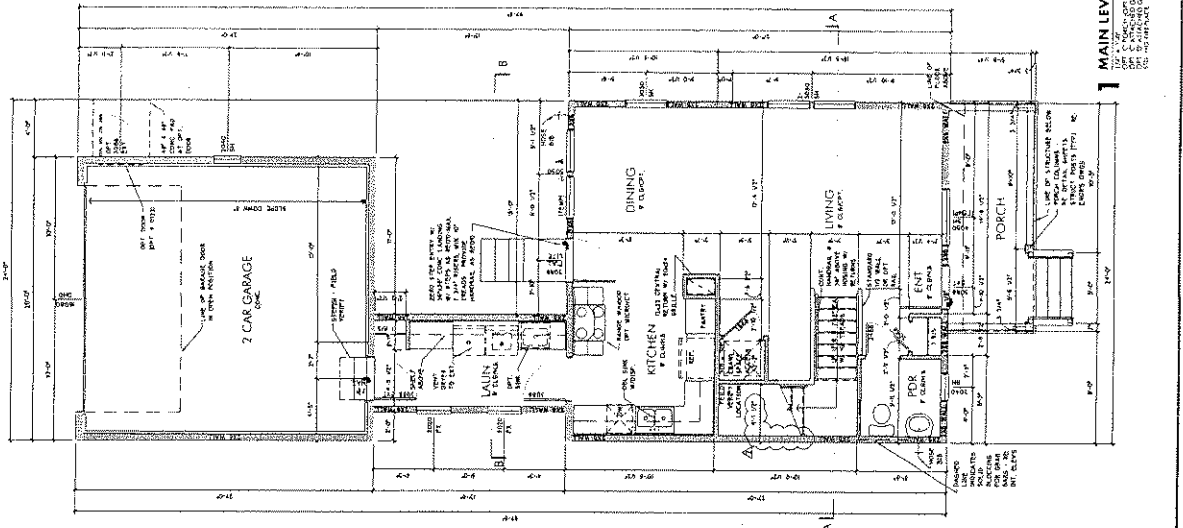





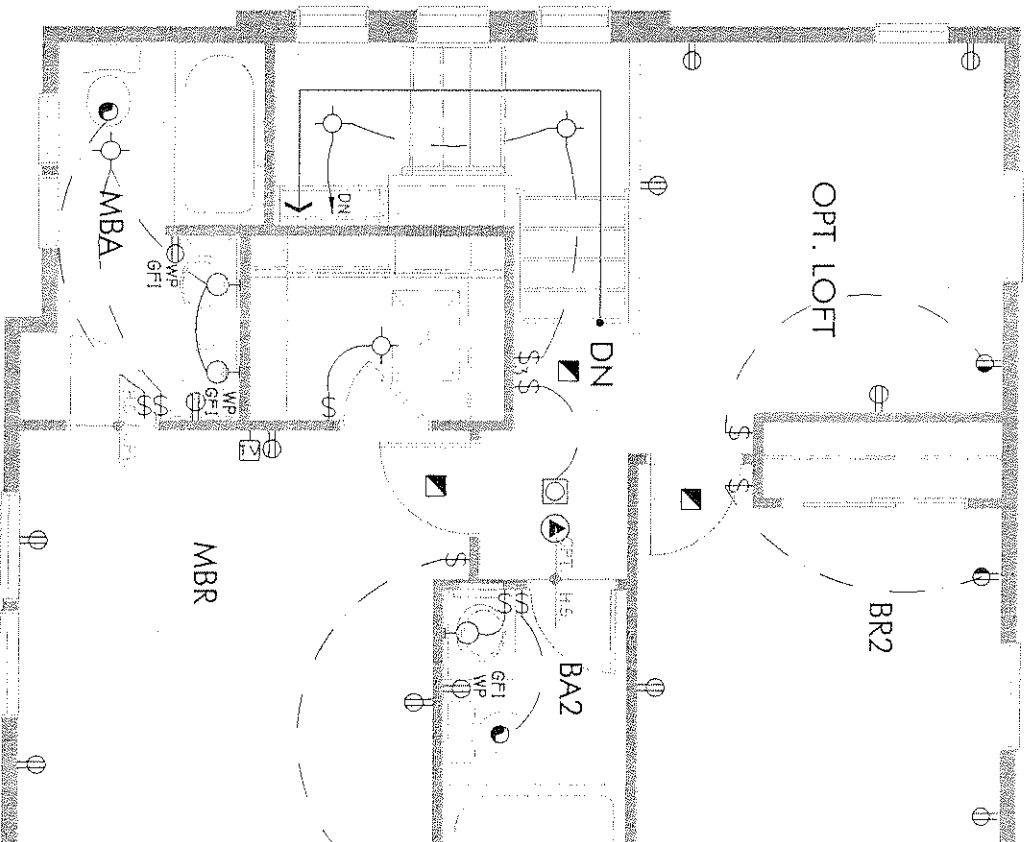
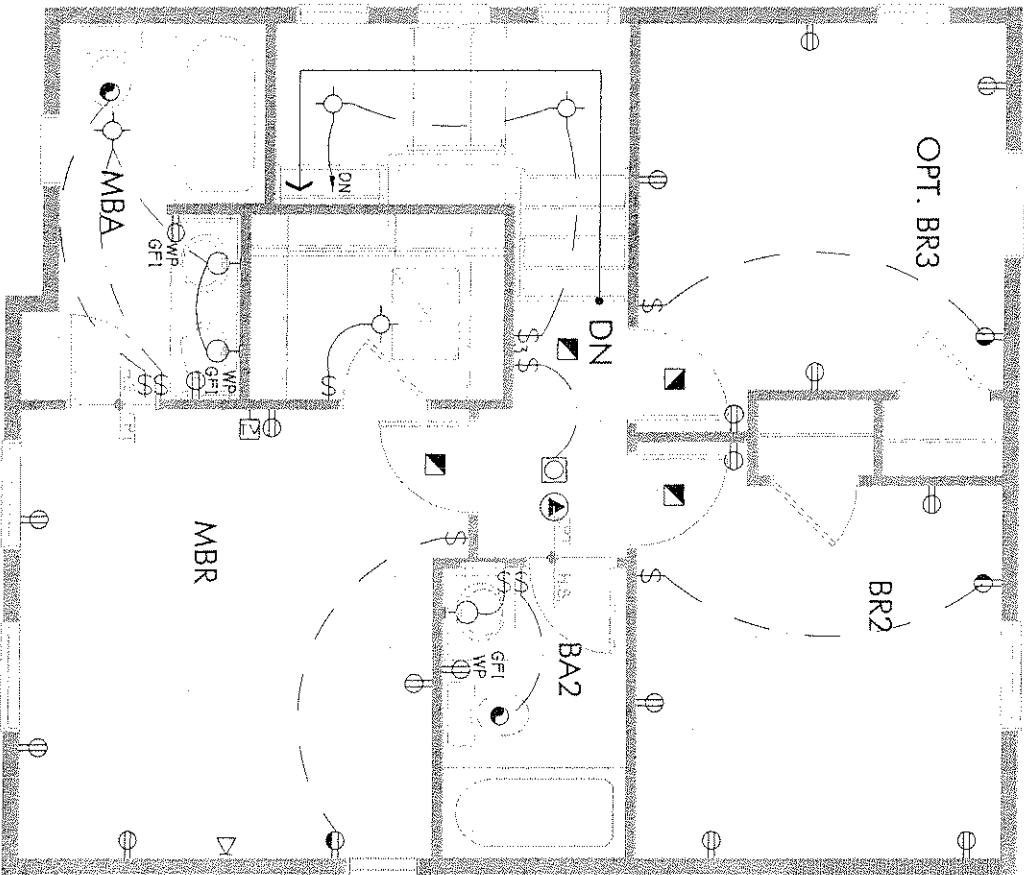





















2 MAIN LEVEL PLAN
1738 S. F. TOWN
DENVER, CO 80213
NEW TOWN BUILDERS
1738 S. F. TOWN
DENVER, CO 80213

ELECTRICAL PLAN



ELECTRICAL LEGEND

	DUPLEX		WALL MOUNTED FIXTURE
	DUPLEX BELOW		CEILING MOUNTED FIXTURE
	GROUND FAULT INTERRUPT DUPLEX		RECESSED CAN FIXTURE
	W.P. GFI WATER PROOF GROUND FAULT INTERRUPT DUPLEX		FLUORESCENT STRIP
	220 V DUPLEX		DIRECTIONAL EYEBALL SPOT FIXTURE
	SWITCH ACTIVATED DUPLEX		EXHAUST FAN
	SWITCH		JUNCTION BOX
	3-WAY SWITCH		GARBAGE DISPOSAL
	4-WAY SWITCH		SMOKE DETECTOR
	DIMMER SWITCH		CARBON MONOXIDE DETECTOR
	ELECTRICAL PANEL		PUSH BUTTON FOR DOOR BELL
	AUDIO/VIDEO PANEL		DOOR CHIME
	TELEVISION CABLE OUTLET		
	PHONE		
	TECHPORT		

ELECTRICAL NOTES

1. PROVIDE POWER FOR FIREPLACE PER MANUFACTURERS

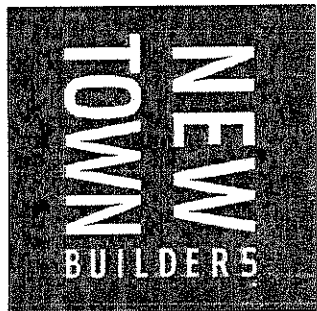

NEW TOWN BUILDERS
 1553 PLATTE STREET
 SUITE 100
 DENVER, COLORADO 80202
 PHONE: 303.707.4400
 FAX: 720.348.1384
 WWW.NEWTOWNBUILDERS.COM

PARK COLLECTION AT BELLE CREEK
 COMMERCE CITY, COLORADO
 ADAM COUNTY

NEW TOWN BUILDERS
 DENVER

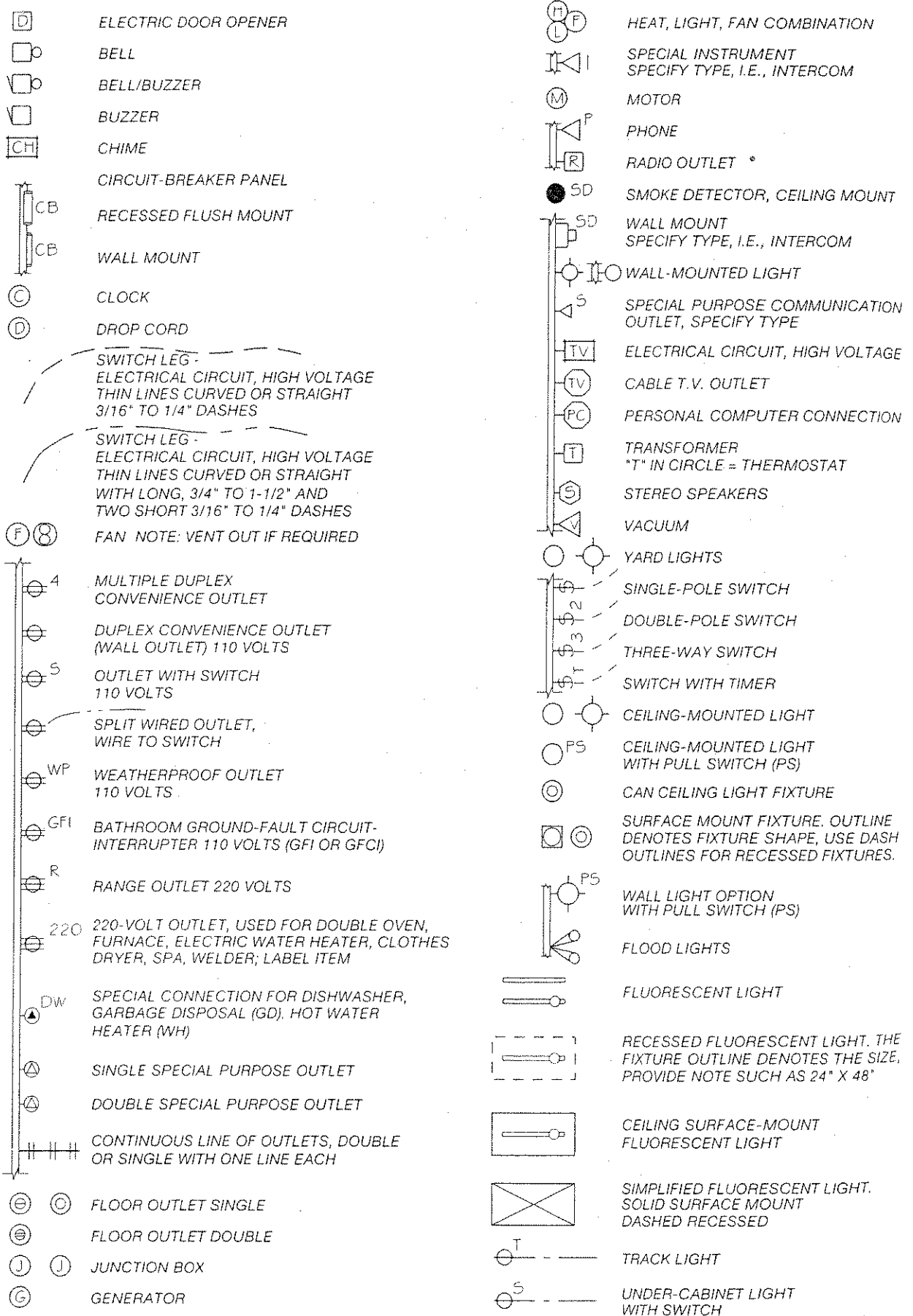

FIGURE 17.2 ■ Common electrical symbols.